

SPECIFICATION



YACHTING PARTNERS
MALTA

183/4 Marina Street,
Pietà, PTA9042,
Malta

+356 21252727
sales@yppm.mt

www.yachtingpartners.com.mt



LOA		14.60 m	47' 11"
Hull length		13.87 m	45' 6"
LWL		13.05 m	42' 10"
Beam		4.79 m	15' 9"
Draft			
shallow keel		1.75 m	5' 9"
L-keel, medium		2.25 m	7' 5"
Displacement			
shallow keel	approx.	13.00 t	28,660 lbs
L-keel, medium	approx.	12.60 t	27,778 lbs
Engine Diesel			
standard	approx.	57 PS	57 hp
option	approx.	80 PS	80 hp
Fuel tank	approx.	200 l	53 gal
Fresh water	approx.	450 l	119 gal
CE Certificate		A - 12	
Design		Berret - Racoupeau	
Interior		Berret - Racoupeau	

460

Mast length above WL	approx.	21.90 m	71' 10"
Upwind sail area	approx.	113.00 m ²	1,216 sq ft
Downwind sail area	approx.	234.00 m ²	2,519 sq ft
Main sail	approx.	64.00 m ²	689 sq ft
Jib	approx.	42.00 m ²	452 sq ft
Genoa	approx.	49.00 m ²	527 sq ft
Reacher	approx.	78.00 m ²	840 sq ft
Gennaker	approx.	170.00 m ²	1,830 sq ft

All measurements/figures are approximate. Errors and omissions excepted. All weights are specified in MLC. Specification and material can be changed without notice. Valid from 2023.07.01 for deliveries until 2024.12.31.

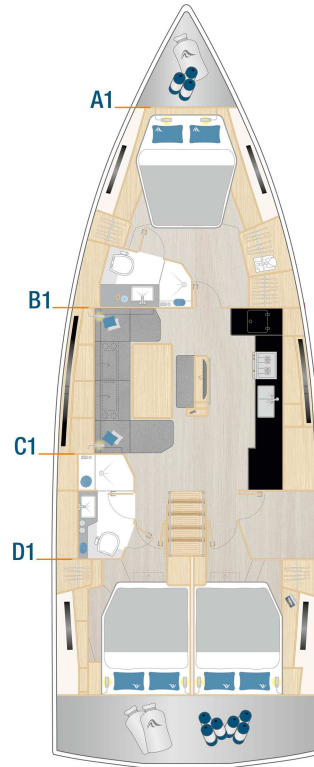

Standard

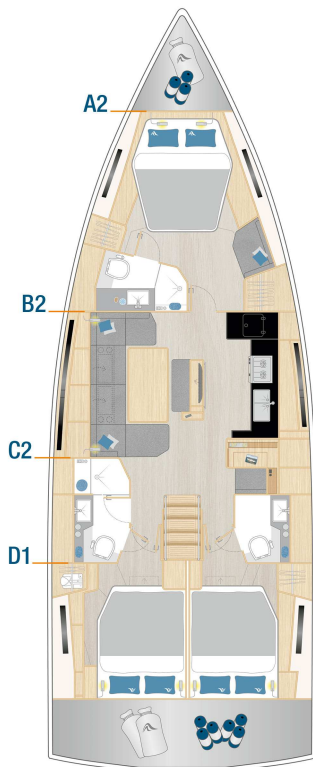

Option

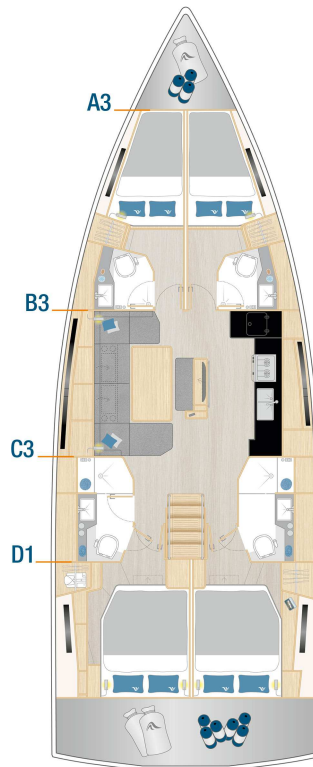

Option

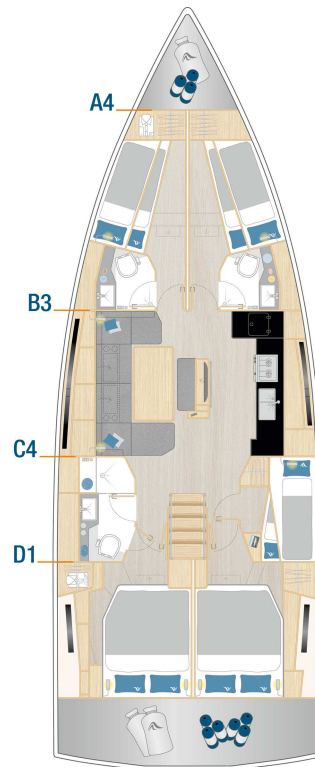

Option

HULL

- 8 hull windows (4 each side)
- GRP hull, isophthalic gelcoat, colour: Signal White (similar RAL 9003), 1st layer vinyl ester resin and balsa sandwich laminat
- Waterline, isophthalic gelcoat, colour: Dark Grey (similar RAL 7043)

KEEL

- L-keel, cast iron, draft: 2.25 m
- GRP rudder with sea-water resistant aluminium shaft and selfaligning bearings

LAYOUT & INTERIOR

- A1: Master cabin with island double berth, 1 locker and 1 big locker and ensuite head with separate shower stall
- B1: Saloon with full functional large L-galley on stb and dining area with bar on port (only with C1 or C2 layout)
- C1: Head with separate shower stall and dayhead door on port and storage room on stb (not with B3 layout)
- D1: 2 aft cabins with VIP cabin on port incl. "Queen size" bed and guest cabin on stb with double berth and storage space
- 3-burner gas stove with oven, waste bin, 12 V fridge approx. 135 l, double stainless steel sink with mixing tab
- Interior furniture in high quality marine plywood, Satin Varnish
- Hanse companionway closing system
- Saloon table, fixed
- Worktop in galley and heads - Black Quartz

WOOD (FURNITURE, FLOORBOARD)

- Furniture - Mahogany Style, Satin Varnish
- Galley cupboard fronts in wood colour
- Floorboard - Acacia

UPHOLSTERY

- Mattresses for all berths
- Upholstery - Monte Carlo, colour: Cream

DECK & OUTSIDE EQUIPMENT

- GRP deck with antislip surface, isophthalic gelcoat, colour: Signal White (similar RAL 9003), 1st layer vinyl ester resin with balsa sandwich core. 2 cockpit lockers, 1 space for life raft, stern locker on port, stowage for running rigging at helm position, anchor locker at bow.

- Twin wheel steering system with emergency tiller
- 2 stainless steel steering wheels with leather cover
- Cockpit table, stainless steel with teak tops, on stb
- Cockpit table, stainless steel with teak tops, on ps
- Pulpit and pushpit, stainless steel
- Railing, incl. stanchions and stainless steel wire
- Covered halyards and control lines lead to cockpit helmposition, organizers and jammers, 4 mooring cleats, handrails on coach roof
- 2 LEWMAR 45 ST EVO manual halyard winches
- Bathing platform, manual fold-out with swimming ladder
- Composite bowsprit with integrated anchor and forestay fitting
- Self tacking jib system
- Mainsheet system
- 8 large and 6 small deck hatches - openable, anchor locker hatch
- 4 large coach roof side windows - openable, 4 portlights in coach roof

RIG & SAILS

- Rig, anodized aluminium, deck stepped, with kicker, standing and running rigging and 2 reefs
- Backstay tensioner, manual
- Manual jib furler
- ELVSTRØM Dacron sails - full battened, main and jib

NAVIGATION & INSTRUMENTS

- Illuminated compass at each helm
- Navigation lights - LED

PROPULSION

- Fuel tank, approx. 200 l
- Engine (Diesel, approx. 57 hp) - saildrive, 3-blade fix propeller
- Throttle control at helm position, stb

EQUIPMENT

- 12 V and 230 V electric system with main panels and 230 V shore power and sockets in cabins and heads
- AGM battery set, capacity: 1x 90 Ah + 1x 160 Ah AGM
- Country Version: EU / AUS
- Battery charger 35 A
- Manual toilet with sea water flush - cabin layout A1 or A2

- Manual toilet with sea water flush - cabin layout C1 or C4
- LPG gas system, stowage for 1 gas bottle
- Black water system (appr. 85 l each bathroom) with deck extraction and seacock for head, electric and manual bilge pump
- Fresh water system with electric pump and 40 l hot water, heated also by main engine
- Fresh water tank, appr. 450 l

SHIPPING & TRANSPORT

- CE - Certificate cat. A - 12, B - 14, C - 16
- Owners manual
- EC - Type Examination Certificate